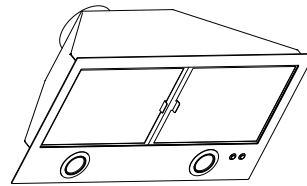
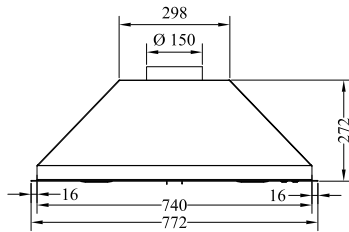
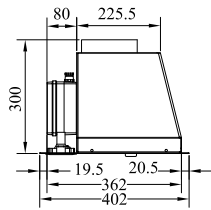

**KAI90-120-150****BUILT-IN PURPOSE  
"PROFESSIONAL" VENT HOODS**

mm 900-1200-1500x400

designed to withstand radiant heat from wood-burning stoves

**KAI90****Stainless steel**

- maximum power (suction) mc/h 900
- 355 W, 4 speed motor
- led lighting with 2 bulbs
- exhaust  $\varnothing$  150 mm
- stainless steel grease filters n°2

Build-in hole dimensions mm 745x375

**KAI120****Stainless steel**

- maximum power (suction) mc/h 900
- 355 W, 4 speed motor
- led lighting with 2
- exhaust  $\varnothing$  150 mm
- stainless steel grease filters n°2

Build-in hole dimensions mm 985x375

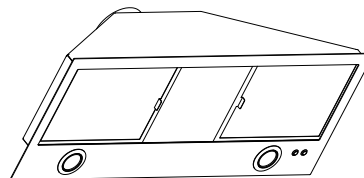
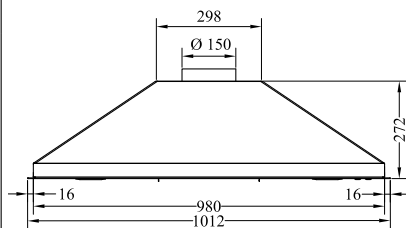
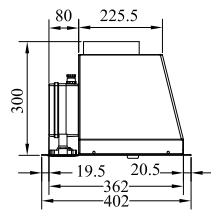
**KAI150****Stainless steel**

- maximum power (suction) mc/h 900
- 355 W, 4 speed motor
- led lighting with 3 bulbs
- exhaust  $\varnothing$  150 mm
- stainless steel grease filters n°3

Build-in hole dimensions mm 1285x375

